

P/N: ER251020S
 SIZE: CC

HIGH PERFORMANCE LITHIUM CELL
 Lithium Thionyl Chloride (Li/SOCl₂)

CROSS REFERENCE
 25-102-150MR, 3B3000, 4287

CELL SPECIFICATIONS

Nominal voltage (@25°C):	3.6V
Rated capacity (discharged at 100mA @150°C, cut-off voltage 2.0V):	9.5Ah
Max continuous discharge current:	300mA
Typical weight:	110g
Cell volume	48cc
Cell diameter (max.):	25.0mm
Cell length (max.):	102.0mm
Operating temperature range:	-20°C to +150°C -4°F to 302°F

Features

- Stainless steel container
- Hermetic glass-to-metal sealing
- Low self discharge
- High rate performance

Applications

- Oil fields
- Exploration
- Aerospace
- Marine
- Detectors / monitors
- Data loggers
- Test equipment

Cell Voltage versus Current and Temperature

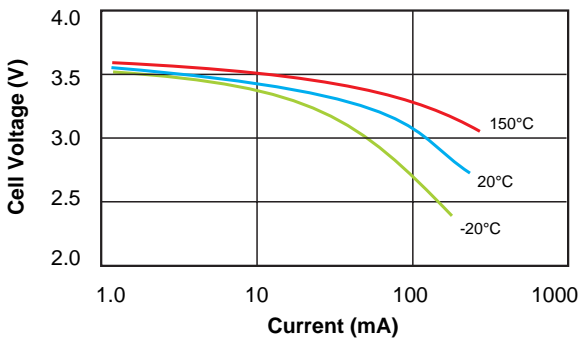

Capacity versus Current and Temperature

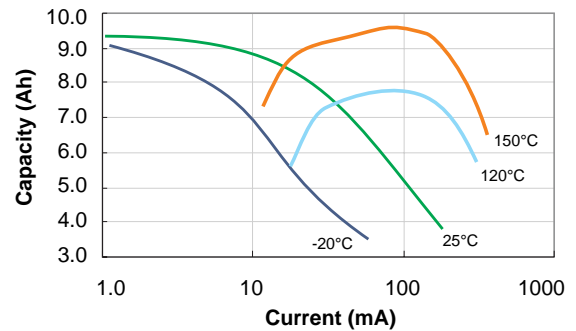

150°C Discharge Performance

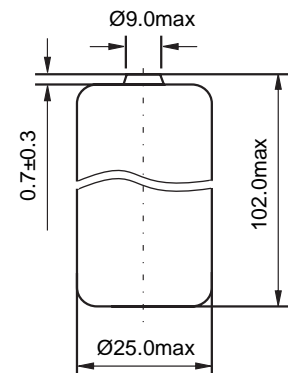
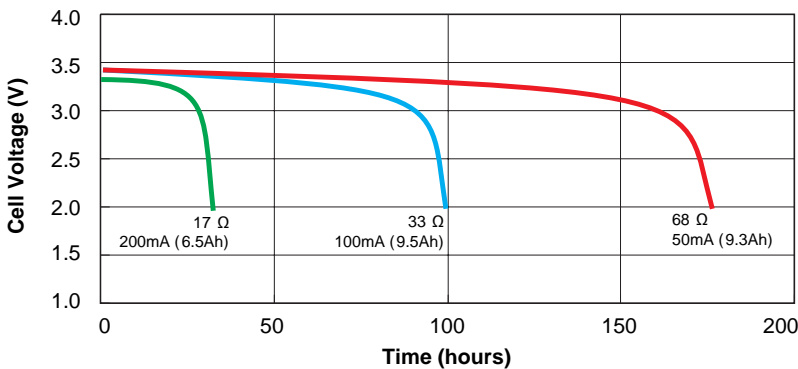

Dimensions in mm

Custom terminations available upon request

Product specifications are subject to change without prior notice. Any presentation in this data sheet concerning performance is for information purpose only and not warranties, either expressed or implied, of future performance.